

# SUITE 820

Work-Ready Loft

FLOOR:

8

AREA:

18,912 SF  
1,756 M<sup>2</sup>

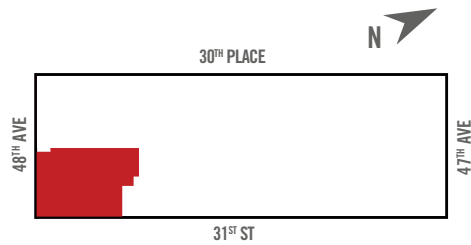

## FEATURES:

- » CURRENTLY IN RAW CONDITION
- » EXCELLENT LIGHT AND VIEWS WITH NORTHERN AND EASTERN EXPOSURE
- » LANDLORD WILL BUILD NBI
- » DIRECT ACCESS TO FREIGHT ELEVATOR
- » APPROX. 12' CEILINGS
- » APPROX. 22' COLUMN SPACING

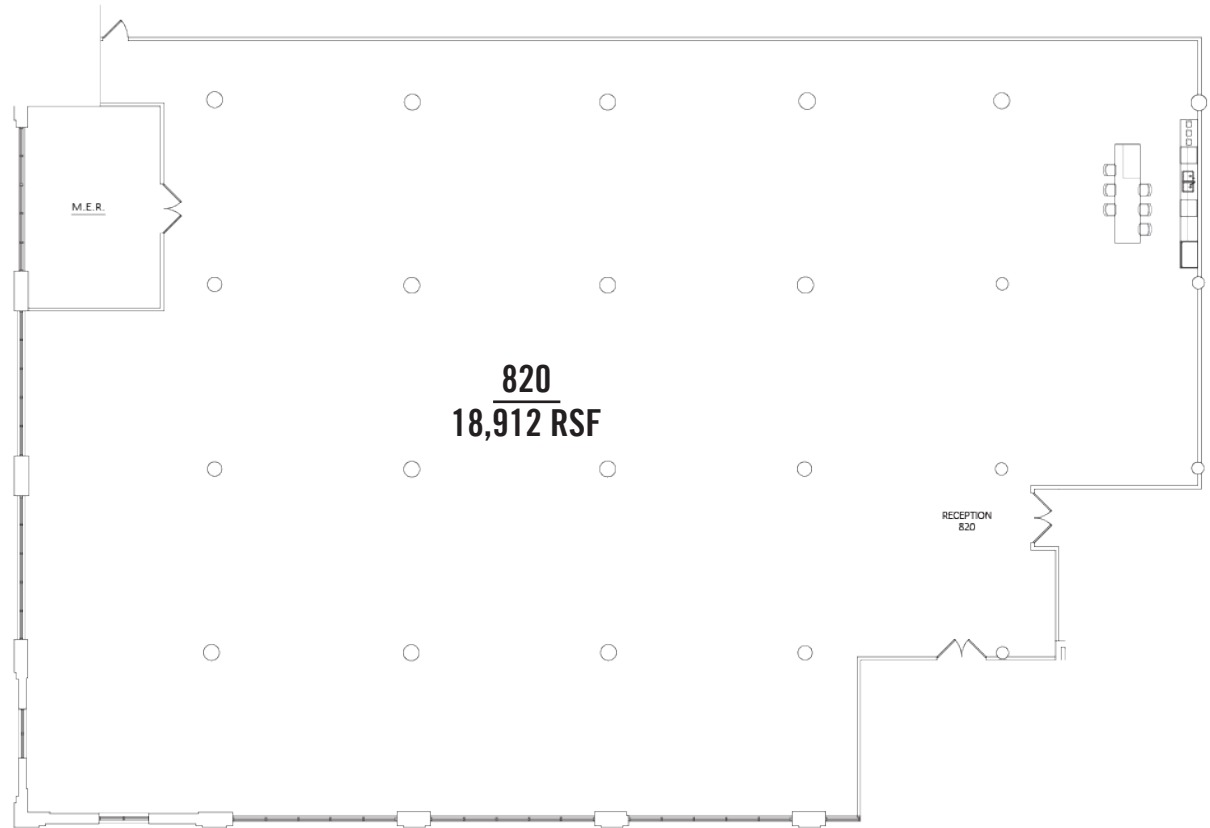

30-30 47<sup>th</sup> Avenue  
Long Island City - NY, NY 11101

CONTACT:  
**212.372.2110**

Howard J. Kessler Jr.  
Howard.Kessler@nmrk.com

