

SUITE 920

Work-Ready Loft

FLOOR: 9
AREA: 15,775 SF
1,466 M²

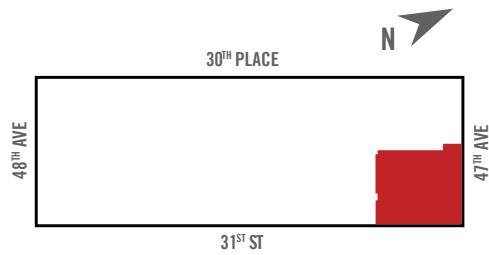

FEATURES:

- » WORK-READY LOFT SPACE
- » EXCELLENT LIGHT AND VIEWS WITH NORTHERN AND EASTERN EXPOSURE
- » CURRENTLY IN RAW CONDITION
- » LANDLORD WILL BUILD NBI
- » DIRECT ACCESS TO FREIGHT ELEVATORS
- » APPROX. 12' CEILINGS
- » APPROX. 22' COLUMN SPACING

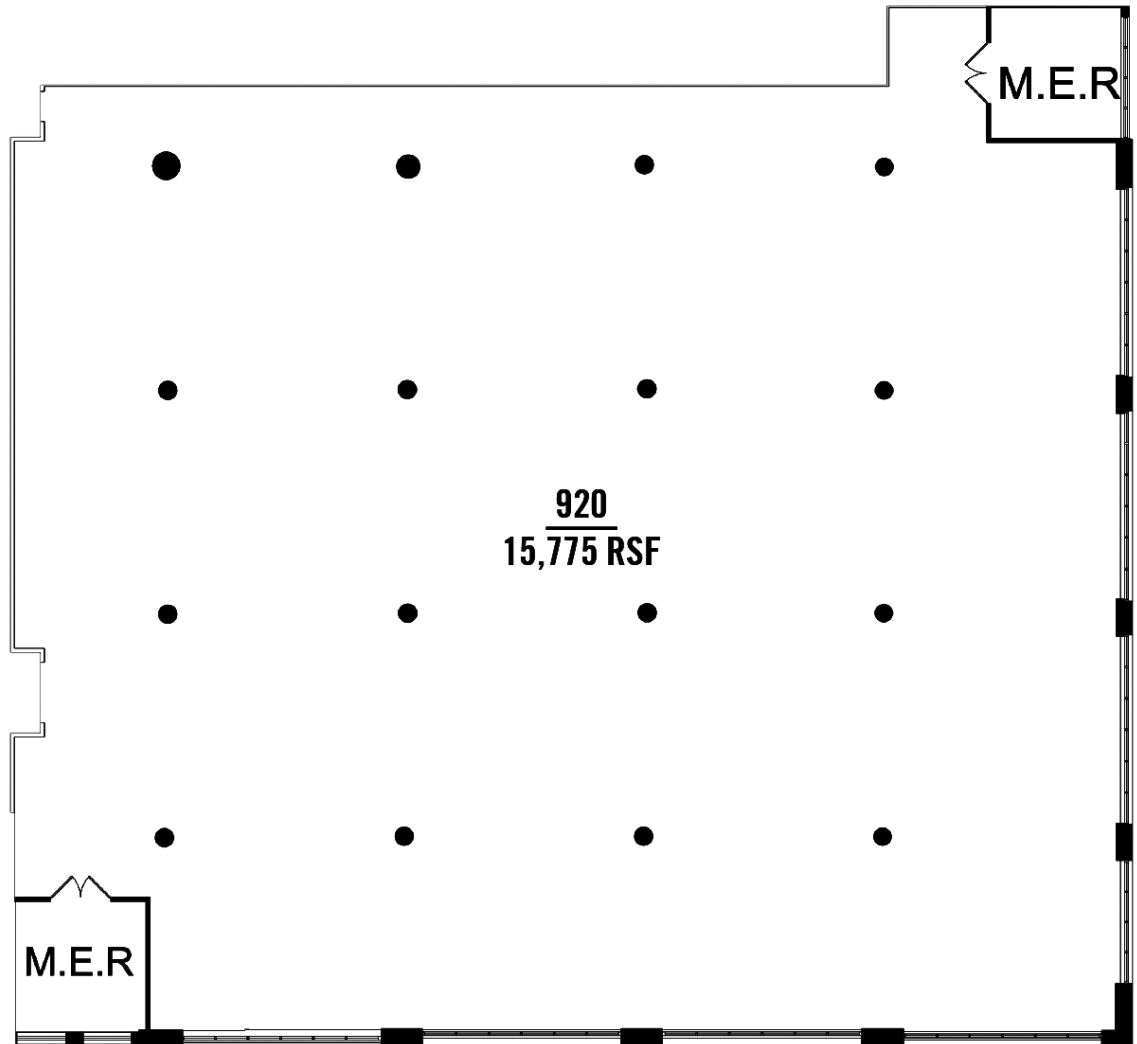

30-30 47th Avenue
Long Island City - NY, NY 11101

CONTACT:
212.372.2110

Howard J. Kessler Jr.
Howard.Kessler@nmrk.com

