

# SUITE 1020

Work-Ready Loft

FLOOR: AREA:  
**10** **42,183 SF**  
**3,919 M<sup>2</sup>**

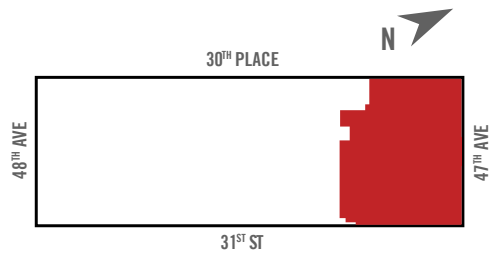

## FEATURES:

- » UNIQUE BUILD-TO-SUIT PENTHOUSE OPPORTUNITY
- » AVAILABLE: OCTOBER 2023
- » 12'-18' CEILING HEIGHTS
- » NEW FULLY FUNCTIONAL WINDOWS AND FEATURED SKYLIGHTS WITH SPECTACULAR LIGHT AND VIEWS
- » DIRECT ACCESS TO FREIGHT ELEVATOR AND LOADING DOCK
- » APPROX. 22' COLUMN SPACING

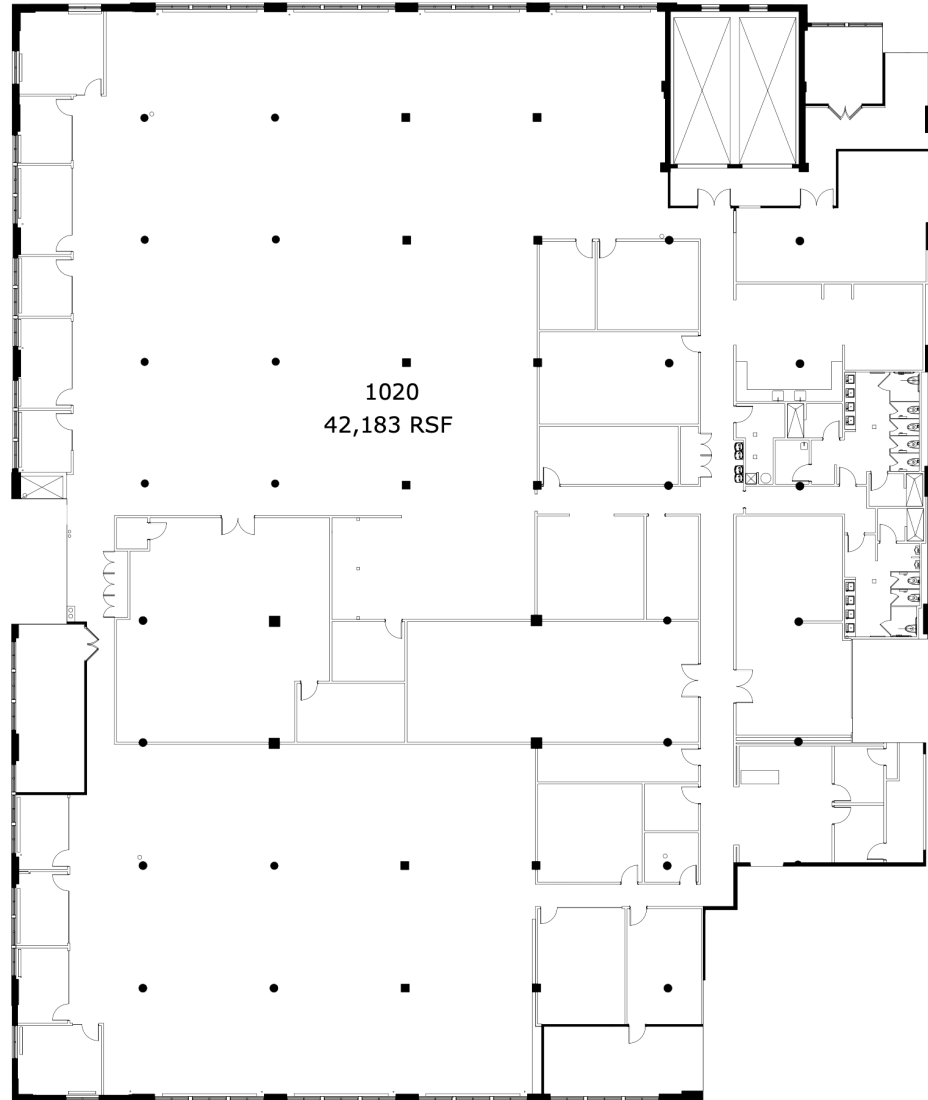

30-30 47<sup>th</sup> Avenue  
Long Island City - NY, NY 11101

CONTACT:  
**212.372.2110**

Howard J. Kessler Jr.  
Howard.Kessler@nmrk.com

